



# NEW TECHNOLOGIES IN PHARMA MACHINES



Designed and manufactured in  
accordance with GMP standards and  
pharmaceutical requirements.



**NEWTECH MACHINES**

## Model NT 240

### FEATURES:

- ◆ The machine is suitable to produce blisters with various foils like PVC, PVC/PVDC, PET, COC, ACLAR, ALU/ALU types of material for forming the blister cavities.
- ◆ The machine is suitable to pack both tablets and capsules.
- ◆ The machine is a flat forming and Flat sealing model.
- ◆ Product feeding is designed based on product shape.
- ◆ Change parts can be fitted with minimum tools.
- ◆ Trim is cut and collected in separate box.
- ◆ The machine has Print registration control system in option.
- ◆ Sealing is Flat sealing and produces best quality of seal without any leak issue.
- ◆ Embossing and perforation station is available as option.
- ◆ The machine is having four servo motors for product feeding, web indexing, punch indexing and punching and pick and place of blisters.
- ◆ Safety guards are made elegant for easy operation support.
- ◆ HMI carry three level password control and can be assigned for individual as per the need.
- ◆ NFD option according to the need can be integrated.
- ◆ Blister machine carry rotary pick and place system for holding the blister and delivering on the conveyor smoothly the completed blister pack.
- ◆ The machine is in built with batch code printing unit.

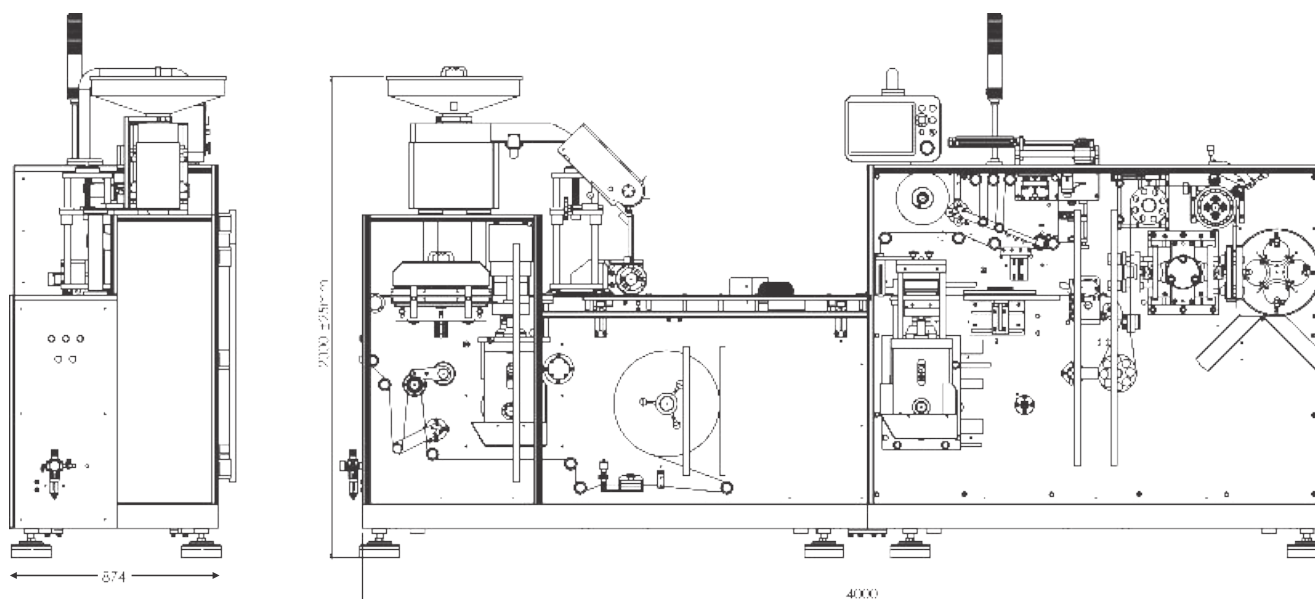

# BLISTER PACKING MACHINE

## Advance Features



### Vertical back cutting

Sealed blister packs are cut in vertical direction. Embossing and perforation inbuilt at same station opposite to cutting tool.



### Rotary pick and place

Vertical packs are picked by means of vacuum while OK packs are rejected at 90 degree and rejected packs at 45 degree.



### Rotary type drum feeding

Drum feeding by servo controlled motion which synchronises accordingly with machine speed. Feeding of products can also be done by direct channel feeding.



### PRC

This system is provided with EYE mark sensor to maintain the position of Pre printed matter of aluminium foil with respect to its formed cavities on blisters.



### Printing system

It is a pneumatic type stereo printing consists of ceramic roller soaked with ink stereo plate contacts with ink roller by linear motion and stamps on lead foil by pneumatic action.



TECHNICAL SPECIFICATIONS OF MODEL NT 240	
Max Foil Width	200mm
Max Forming Advance	140mm
Base Film Thickness Max	0.2mm - 0.4 mm
Lid Foil Thickness Max	0.02 mm - 0.06 mm
Forming Area	190 X 138
Speed	40 Cycles/min (Cold Forming)
	40 Cycles/min (Thermo Forming)
Max Forming Depth	12mm

## Optional features

- ◆ Pin hole detection system
- ◆ Non-filled camera system
- ◆ Ink-jet printing system

## Packing Materials

- ◆ Base film thermoformable PVC, PVC with PE/PVDC, COC, ACLAR, PET
- ◆ Cold forming - tri laminated aluminium
- ◆ Lidding foil - heat sealable aluminium

## Servo controlled motion



Drum feeding



Web indexing



Punch indexing



Cutting & pick and place

## Model **NT 300** Multi Product

### FEATURES:

- ◆ The machine is suitable to produce blisters with various foils like PVC, PVC/PVDC, PET, COC, ACLAIR, ALU/ALU types of material for forming the blister cavities. The machine offered will not have an alu/alu facility as this was not needed currently for the pack design submitted.
- ◆ The machine is suitable to pack both tablets and capsules.
- ◆ The machine is a flat forming and Rotary sealing model
- ◆ Care taken to clean the film while in transport in the machine.
- ◆ The web clamping system is designed to ensure that the web do not reverse.
- ◆ Product feeding is designed based on product shape and in the current format designed it will be shutter gate feeder.
- ◆ Care is taken in such a manner that there are no cross contamination on product feeding.
- ◆ Change parts can be fitted with minimum tools.
- ◆ Trim is cut and collected in separate box.
- ◆ The machine has Print registration control system in built.
- ◆ Sealing is Rotary sealing and produces best quality of seal without any leak issue.
- ◆ Embossing and perforation station is available.
- ◆ The machine is having four servo motors for product feeding web indexing, punch indexing and punching and pick and place of blisters.
- ◆ Safety guards are made elegant for easy operation support.

- ◆ HMI carry three level password control and can be assigned for individual as per the need.
- ◆ NFD option according to the need can be integrated.

- ◆ Blister machine carry rotary pick and place system for holding the blister and delivering on the conveyor smoothly the completed blister pack.
- ◆ The machine is in built with batch code printing unit.

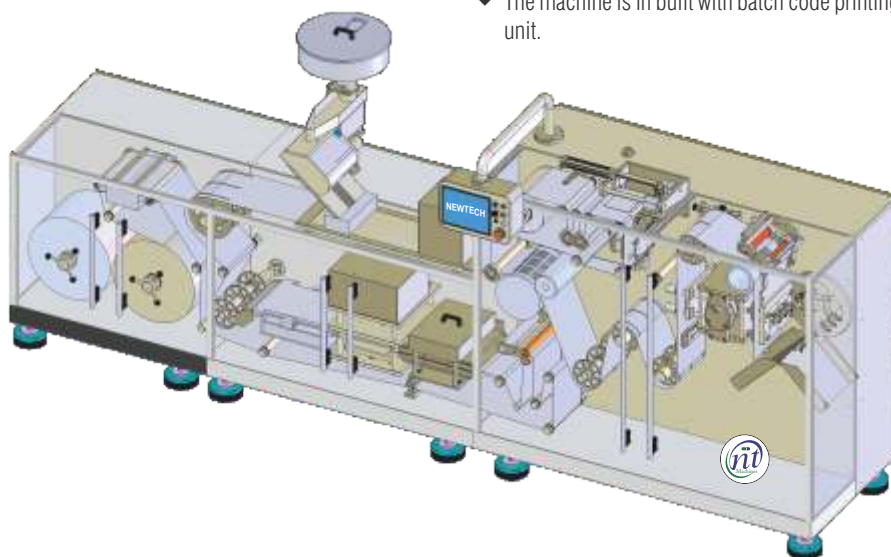

### TECHNICAL SPECIFICATIONS OF MODEL NT 300 MULTI PRODUCT

Max Foil Width	300mm
Max Forming Advance	240mm
Base Film Thickness Max	0.25mm – 0.3 Mm
Lid Foil Thickness Max	0.02 Mm – 0.04 Mm
Forming Area	290 X 234
Speed	40 Cycles/min (Cold Forming)
	50 Cycles/min (Thermo Forming)
Max Forming Depth	12mm

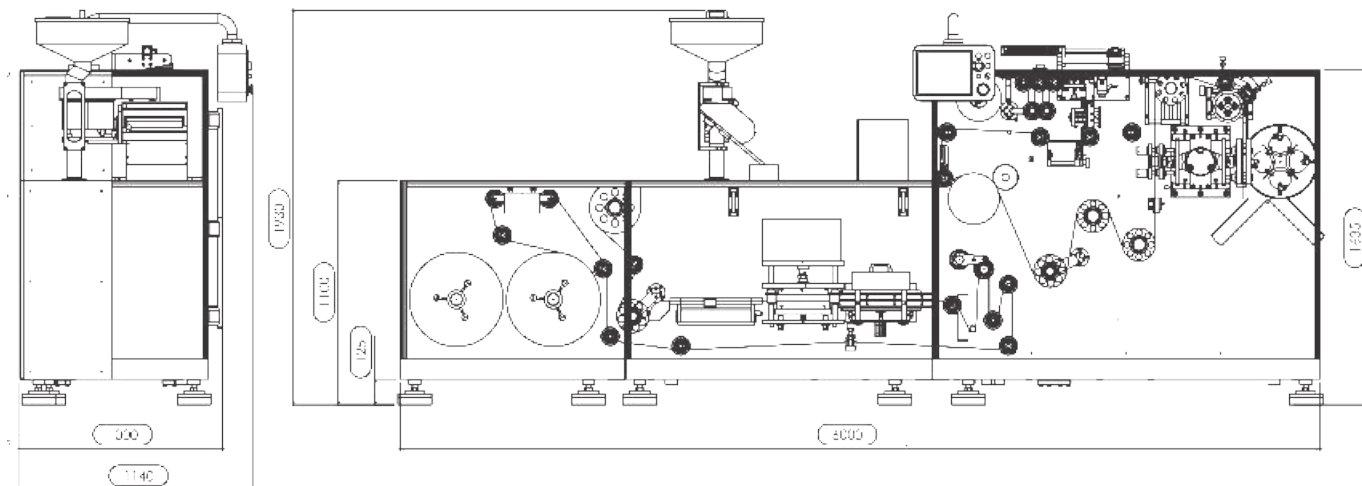

## Model NT 200

### FEATURES:

- ◆ The machine is suitable to produce blisters with various foils like PVC, PVC/PVDC, PET, types of material for forming the blister cavities. This machine is meant only for PVC/Alu blisters.
- ◆ The machine is suitable to pack both tablets and capsules.
- ◆ The machine is a flat forming and Rotary sealing model.
- ◆ Product feeding is designed based on product shape.
- ◆ Change parts can be fitted with minimum tools.
- ◆ Trim is wound on a rotary bobbin in the machine.
- ◆ The machine has Print registration control system in option.
- ◆ Sealing is Rotary sealing and produces best quality of seal without any leak issue.
- ◆ Embossing station is available as option.
- ◆ The machine is having two servo motors for web indexing.
- ◆ Safety guards are made elegant for easy operation & safety.
- ◆ HMI carry three level password control and can be assigned for individual as per the need.
- ◆ NFD option according to the need can be integrated.

### TECHNICAL SPECIFICATIONS

Machine model	: NT 200
Hopper capacity	: 15L
Format size	: 250 x 180mm
Advance max	: 180mm
Max Film Width	: 250mm
Cycles of operation	: 40-50 cycles/min (Thermo Forming)
Power	: 16 HP
Supply	: 415V AC 50 Hz.

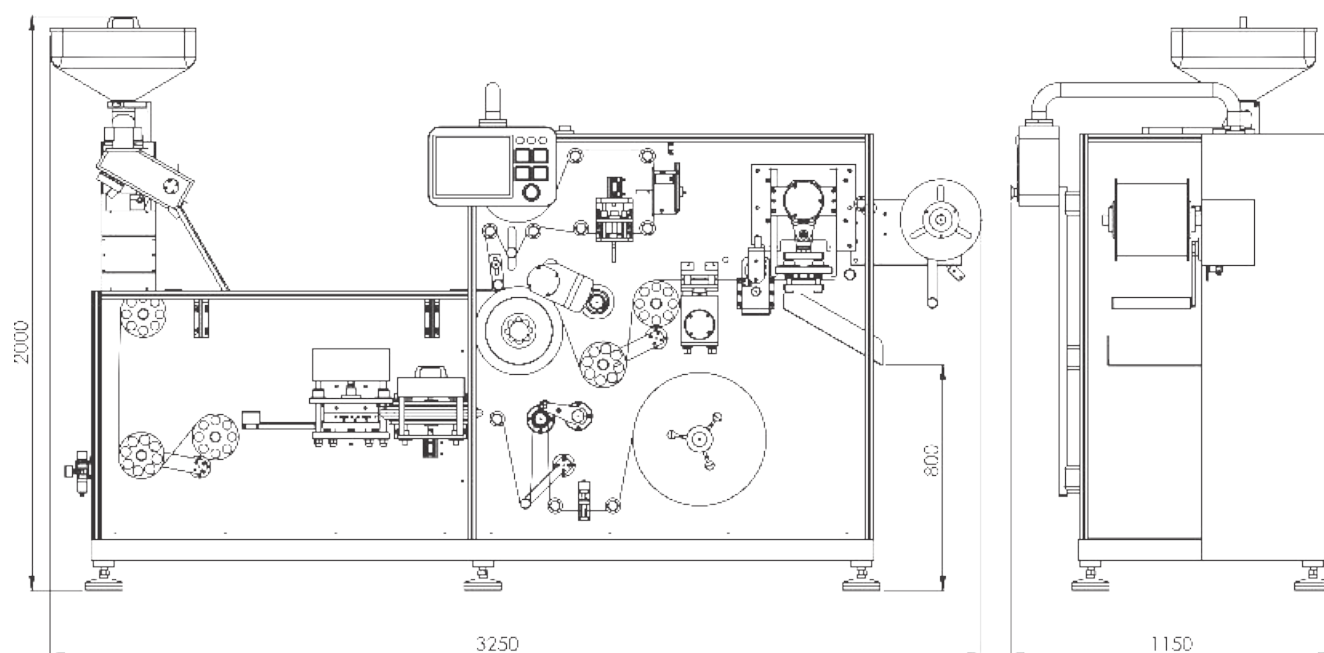
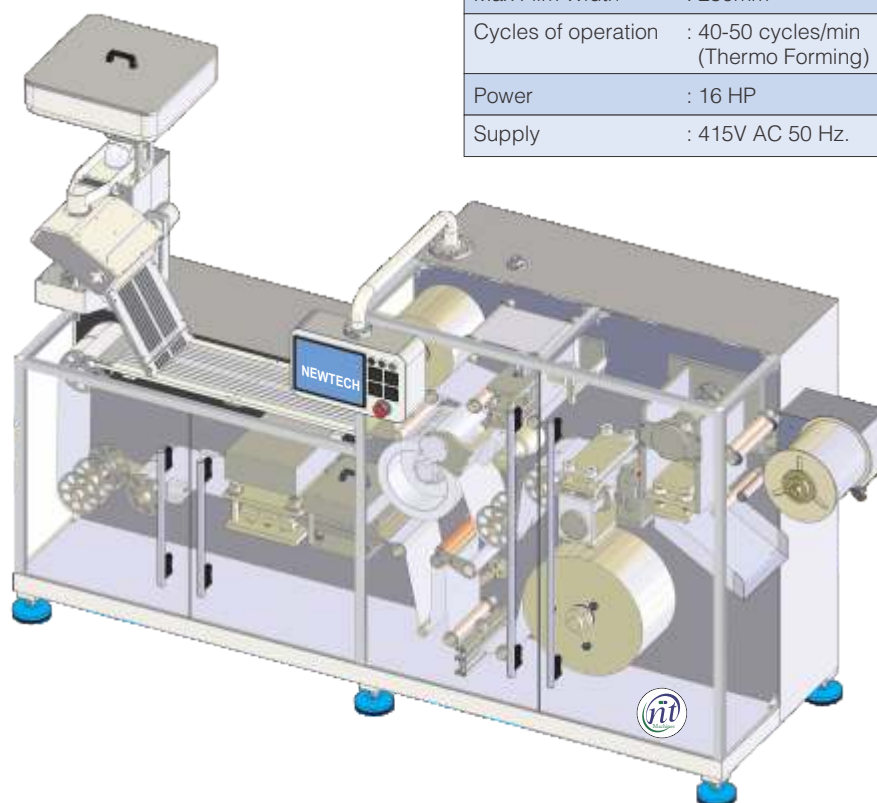

## Model NT 120

### FEATURES:

- ◆ The machine is suitable to produce blisters with various foils like PVC, PVC/PVDC, PET, COC, ACLAR, ALU/ALU types of material for forming the blister cavities.
- ◆ The machine is suitable to pack both tablets and capsules.
- ◆ The machine is a flat forming and Flat sealing model.
- ◆ Product feeding is designed based on product shape.
- ◆ Change parts can be fitted with minimum tools.
- ◆ Trim is wound after punching.
- ◆ The machine has Print registration control system in option.
- ◆ Sealing is Flat sealing and produces best quality of seal without any leak issue.
- ◆ Embossing and perforation station is available as option.
- ◆ The machine is having one servo motor for web indexing.
- ◆ Safety guards are made elegant for easy operation.
- ◆ HMI carry three level password control and can be assigned for individual as per the need.
- ◆ The machine is in built with batch code printing unit.

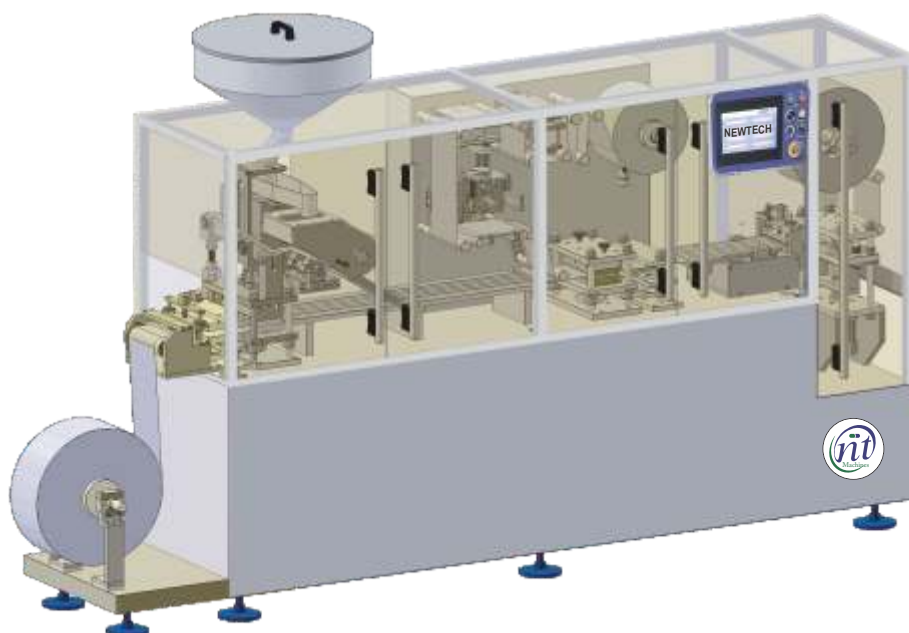

### TECHNICAL SPECIFICATIONS OF MODEL NT 120

Type of forming	Thermo forming, Cold forming
Output	Above 20 cycles/min
Forming area	98 X 150 mm
Forming depth	12mm
Pack advancement	Max-100mm, Min-30mm
Max roll dia (base foil)	450mm X 160mm
Max roll dia (lidding foil)	270mm X 160mm

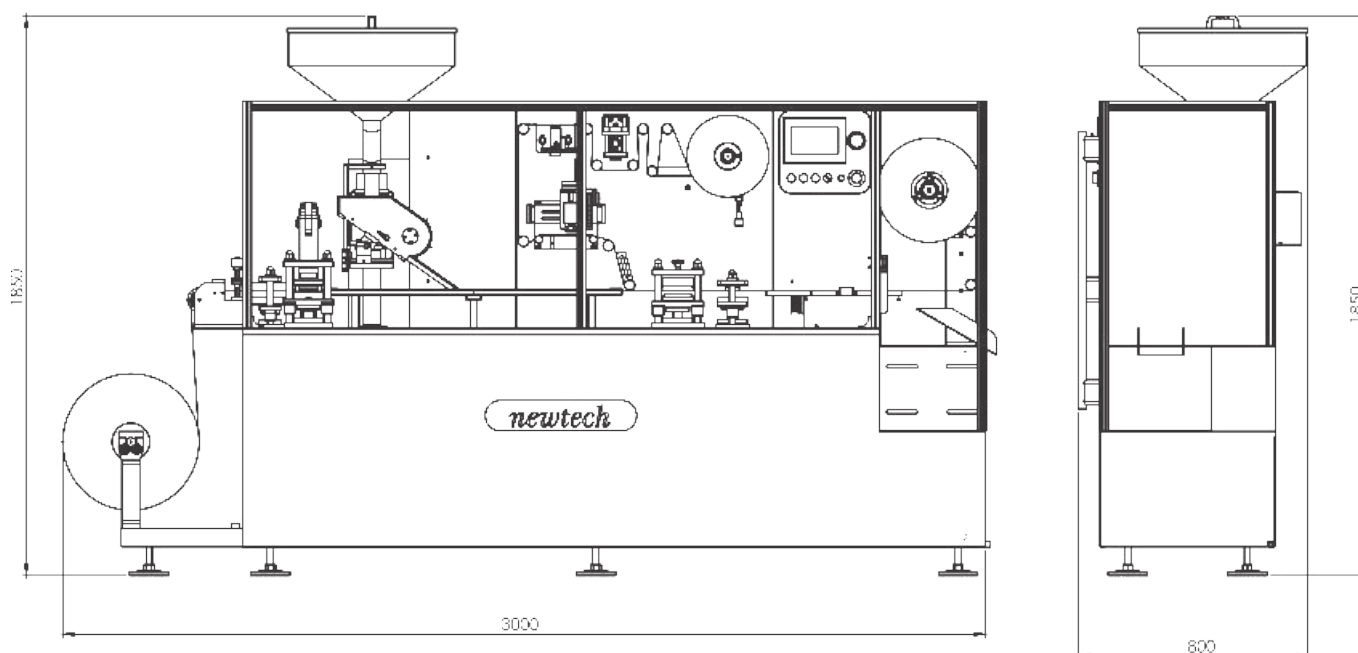

# BLISTER PACKING MACHINE

## Model **NT 100** (Eco Bliss)

### FEATURES:

- ◆ This machine is used for small batch production for R&D need.
- ◆ Machine can adopt any forming films like PVC, alu/alu, Aclair, PP, PET etc.
- ◆ The machine is designed compact to ensure small blisters can be produced for any clinical trials in R&D.
- ◆ It is supported by winding the trim rather than cutting as in small machine it is difficult to separate the trim without mixing.
- ◆ Winding the trim will be elegant and easy to scrap it later.
- ◆ The machine is PLC controlled with an HMI to do parameter setting.
- ◆ Since this is small quantity production, no feeding system is adopted and the products are to be manually filled in formed blisters.

### TECHNICAL SPECIFICATIONS

Compact model NT 100 (Eco Bliss)	
Forming film	0.25mm-0.4mm
Lidding foil	0.02mm to 0.06mm
Film width	100
Advance	70 mm
Output	8-10 Cycles/min (Cold Forming & Thermo Forming)

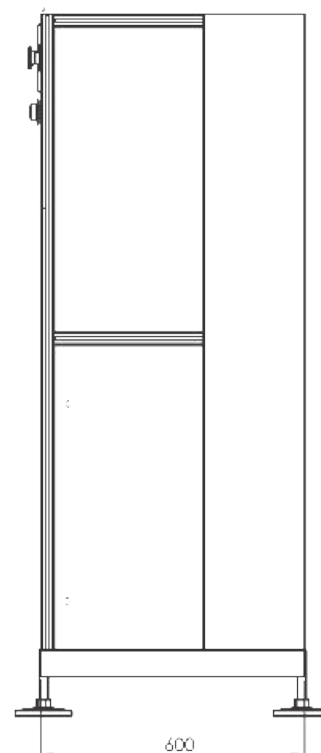
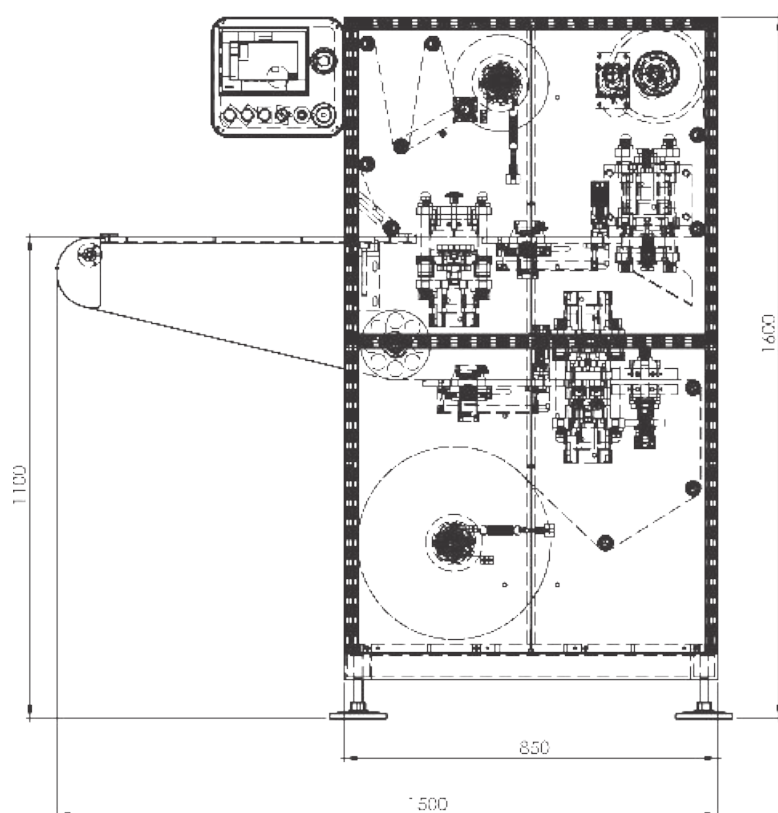
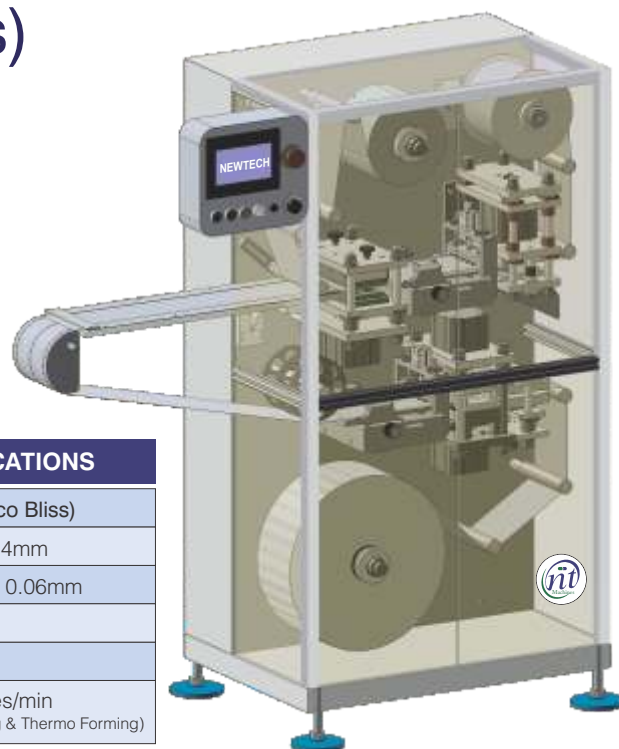

## Model **NT 60** (Meco Bliss)



The machine with its, is best suited for the production of industrial quality blisters for:

- ◆ Clinical trials
- ◆ Stability testing
- ◆ Marketing samples

### FEATURES:

- ◆ Machine Frame Cladded with SS 304
- ◆ Compact Model Conforming to GMP Standards
- ◆ Single Station with Pneumatic Mechanism
- ◆ PLC with user friendly MMI Interface
- ◆ Stay time option for Better Forming and Sealing
- ◆ Capable of producing blisters by Thermo Forming & Cold Forming
- ◆ Can handle a varied type of base & lidding foils
- ◆ Guard for safety
- ◆ Operator friendly & maintenance free
- ◆ Emergency Stop Switch
- ◆ Tool less Easy and Quick Change Over System
- ◆ No skilled operator required
- ◆ Batch Code Embossing & Perforation - Optional

Operations such as thermoforming of PVC, cold forming, sealing/ coding/ perforation and punching are carried out on the same machine due to a rapid and simple change of tools and without extra keys or experienced staff. On demand, tailor-made projects can be developed according to the customer's real needs, manufacturing Change parts with different blister dimension/ configuration/ quantity.

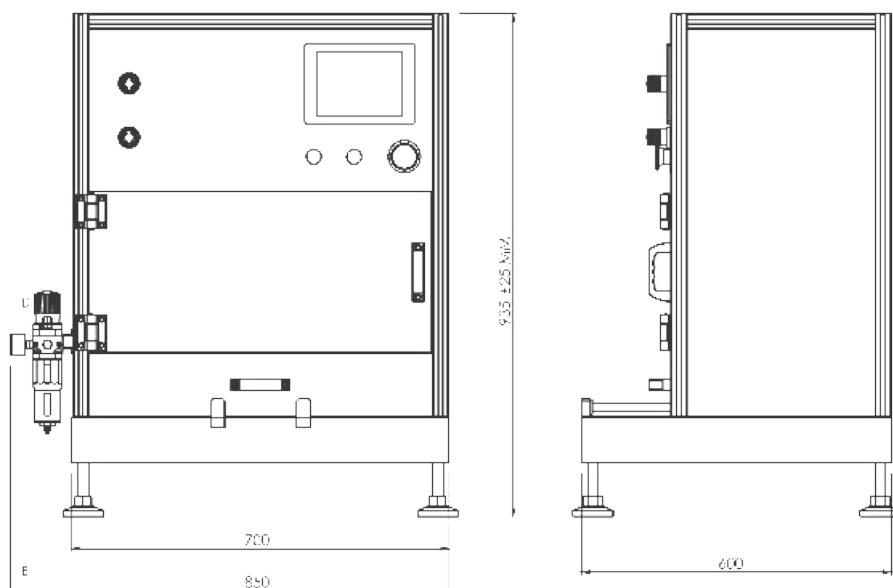

### TECHNICAL SPECIFICATIONS OF MODEL NT 60 (Meco Bliss)

Model	MECO BLISS	
	PVC-ALU	ALU-ALU
Blister Type	PVC-ALU	ALU-ALU
Max. Cycle Speed / min.	3-5 Cycles	
No. of Packs per Cycle	2	1
Max. Format Area	150 mm x 100 mm	
Max. Blister Size *	90 mm (W) x 140 mm (L)	90 mm (W) x 140 mm (L)
Max. Forming Depth	12mm In Thermoforming and 12mm in Cold Forming	
Standard Electrical Utility	110V/230V, Single Phase, 50/60 Hz	
Power Consumption (includes Integral heating)	2 Kw	
Compressed Air Consumption	6 ~ 9 Bar (7 ~9 CFM)	
Cooling Water Consumption	2ltr/hr at 12 to 15o C @ 3 bar pressure	
Machine Footprint (incl. Control Panel)	500 mm x 650 mm x 1500 mm	
Net Weight	350 kg	



## Model **NTTC 120** (Tablet Counting)

### SYSTEM DESCRIPTION:

- ◆ The HDPE containers are loaded on the conveyer manually.
- ◆ These containers will be carried forward on the belt conveyer.
- ◆ Minimum level sensors are placed in position and once the level is attained on accumulation on conveyer, the star wheel provided will receive the container and start Indexing.
- ◆ The indexing drive is through servo motor so the indexing position is repeatedly maintained.
- ◆ Two stations are located where a Hopper, linear feeder, peddle feeder is placed.
- ◆ Beneath the peddle feeder a feeding channel is mounted.
- ◆ The end portion of the feeding channel is split in such a manner that 25 tablets height position is split and mounted on a slide activated with pneumatics.

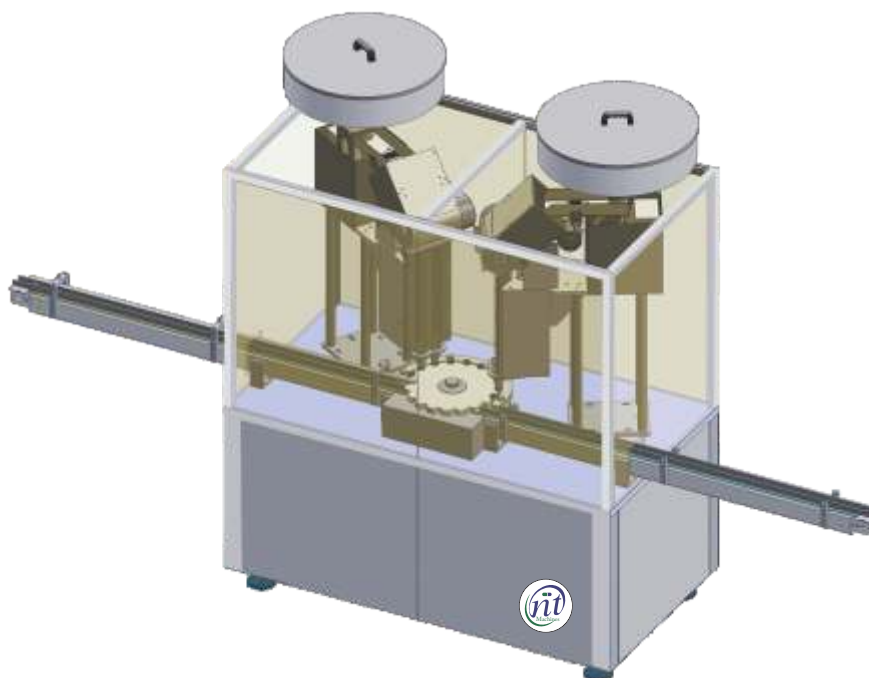

### TECHNICAL SPECIFICATIONS OF MODEL NTTC 120 (Tablet Counting)

Number of tablets in bottle	: 100
Bottle size	: mouth dia 24mm.
Height	: 43mm
Servo drive	: 400 watts
Out put	: 80 - 100 bottles per min.
Power	: 0.75HP
Machine foot print	: 1.6 m x 1 m without conveyer.

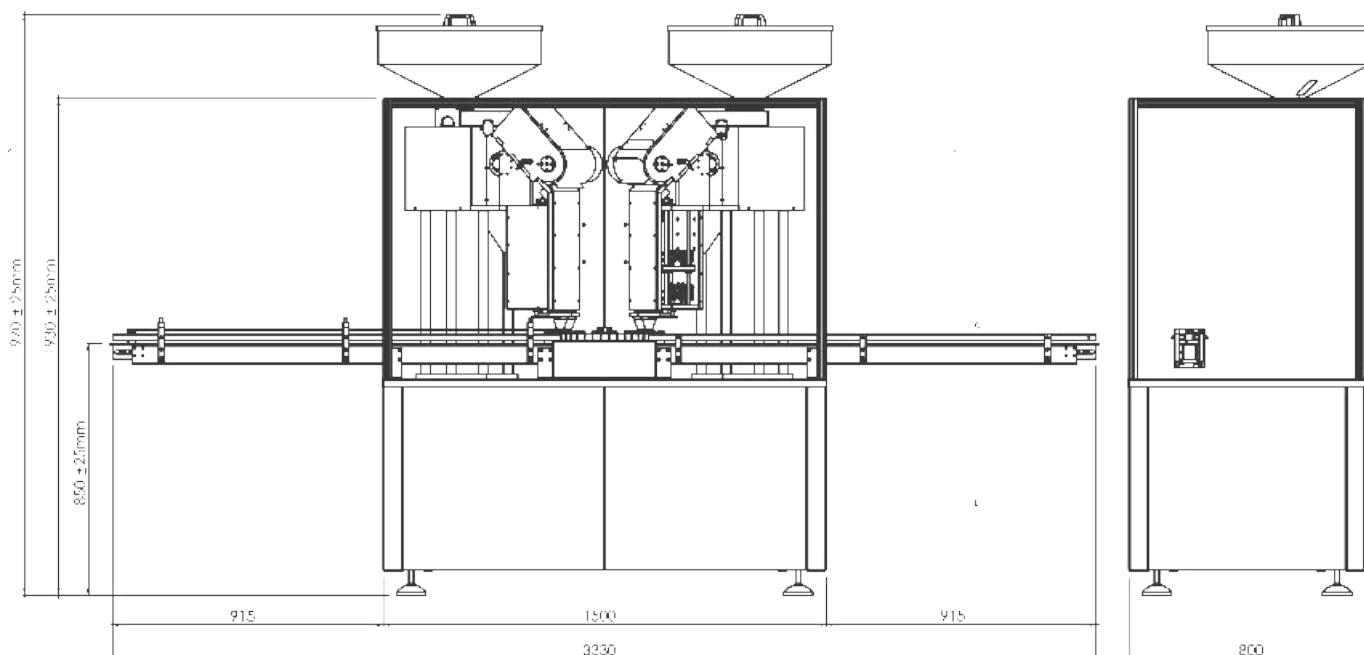

## Fully Automatic **CARTONING**

### FEATURES:

- ◆ This machine is suitable for packing blisters, tubes, ampoules and other related objects into boxes.
- ◆ It can be run continuously and the highest speed can up to 260boxes/min.
- ◆ It has advantages of high packing efficiency and good quality, and is high-tech product with structure of mechanical-electrical integration.
- ◆ This machine can fold leaflet, open box, insert blister into box, emboss batch number and then close or seal automatically.
- ◆ It adopts frequency inverter to adjust speed, human machine interface to operate, PLC to control, and photoelectric to supervise and control each station. So that once something unexpected happens speed its running,
- ◆ It will stop and display the reasons automatically, which can solve the troubles in time.
- ◆ This machine can be used separately, and also can be linked to other machine to be a production line.



Note: this machine can also equip hot melt glue device to do hot melt glue sealing for Boxes.

MAIN TECHNICAL PARAMETERS				
Model	NTC-80	NTC-120	NTC-150	NTC-400
Production capacity	50-70 boxes/min	90-110 boxes/min	110-130 boxes/min	200-300 boxes/min
Size of box(lxwxh)	(50-190)x(25-90)x(15-70)mm	(50-190)x(25-120)x(12-70)mm	(50-190)x(25-90)x(15-70)mm	(200x80x70) (65x25x15)
Specification of box	250-300g/m <sup>2</sup>	250-300g/mm <sup>2</sup>	250-300g/m <sup>2</sup>	250-300g/m <sup>2</sup>
Size of leaflet(lxw)	(110-260)x(100-180)mm	(110-260)x(100-180)mm	(110-260)x(100-180)mm	(260x180)x(110)mmx100
Specification of leaflet	55-70g/m <sup>2</sup>	55-70g/m <sup>2</sup>	55-70g/m <sup>2</sup>	55-65g/m <sup>2</sup>
Air consumption	10m <sup>3</sup> /h	10m <sup>3</sup> /h	10m <sup>3</sup> /h	20m <sup>2</sup> /h
Total Power	380V 50HZ 1.5kw	380V 50HZ 1.5kw	380V 50HZ 1.5kw	380V 50HZ 6.9kw
Overall Dimension(lxhxw)	3300x1320x1700mm	3300x1200x1700mm	3300x1200x1700mm	4500x1460x1800mm
Weight	1200kg	1500kg	1500kg	3000kg

## Semi-Automatic **CARTONING**

### FEATURES:

- ◆ This semi-automatic cartooning is specially designed to pack small batch quantities production.
- ◆ This can be used to pack physician sample blisters, bottles, vials with inserts.
- ◆ The product to be loaded manually into the carton.
- ◆ With low cost the space need for this machine is small.
- ◆ Change over time is low to 20-30 min only.
- ◆ The parts are treated for its life and work on long lasting cycle and clean.
- ◆ Suitable for medicine, food, cosmetic, etc packing needs.



### TECHNICAL SPECIFICATIONS OF SEMI AUTOMATIC CARTONING

Carton size (min)	: 20 x 20 x 60 mm
Carton size (max)	: 80 x 80 x 200 mm
Production speed	: 20 - 60 cartons per min. (since the products are loaded manually, the output is based on operator skill sets.)
Power supply	: 220 v, 50/60 Hz. (to specify at the time of order)
Motor Horse power	: ¼ AC motor
Foot print	: 1480 (L) x 900 (W) x 1250 (H) mm
Machine weight	: 350 kgs.





## Company Overview:

Founded in 2016, Newtech machines had been engaged in design of state of art blister packing machine for medium and high speed needs of the pharmaceutical industry. Newtech can also offer end of line packing solutions to the need which are custom designed for the packing needs. Well qualified and Experienced team is available in design to consider good reliability in endurance. All our designs are worked on solid works software.

A pursuit of a goal of achieving good quality and meeting customer's need has been Newtech's commitment to a rigorous implementation of quality manufacturing. We work on Design qualification and support with the needed Documentation for the Industry.

Our R&D are in the process of adding other range of packing machines as well for the different needs of the industry.

## Philosophy:

Service, quality, R&D, Innovation. Harmonious relationship between employer and employees, "win-win" cooperation with suppliers to create brightening prospects of Newtech.

Newtech operation is based on "Sincerity and Trust" as its business spirit in an effort to benefit other people as well as oneself.

## Operation Goals:

Strengthen our capacity of R&D and innovation and quality control in increase our competitiveness. Intensify the quality management system which has long been improved incessantly to further achieve a goal of sustainable development for Newtech.



## NEWTECH MACHINES

C-88, Building Bo. 5, Mittal Industrial Estate  
Marol Naka, Andheri (East), Mumbai - 400 059.  
Mob.: +91-9967275760  
E-mail: rspk0512@gmail.com  
Website: www.newtechmachines.co.in

